

6.00 MT. WIDE ROAD

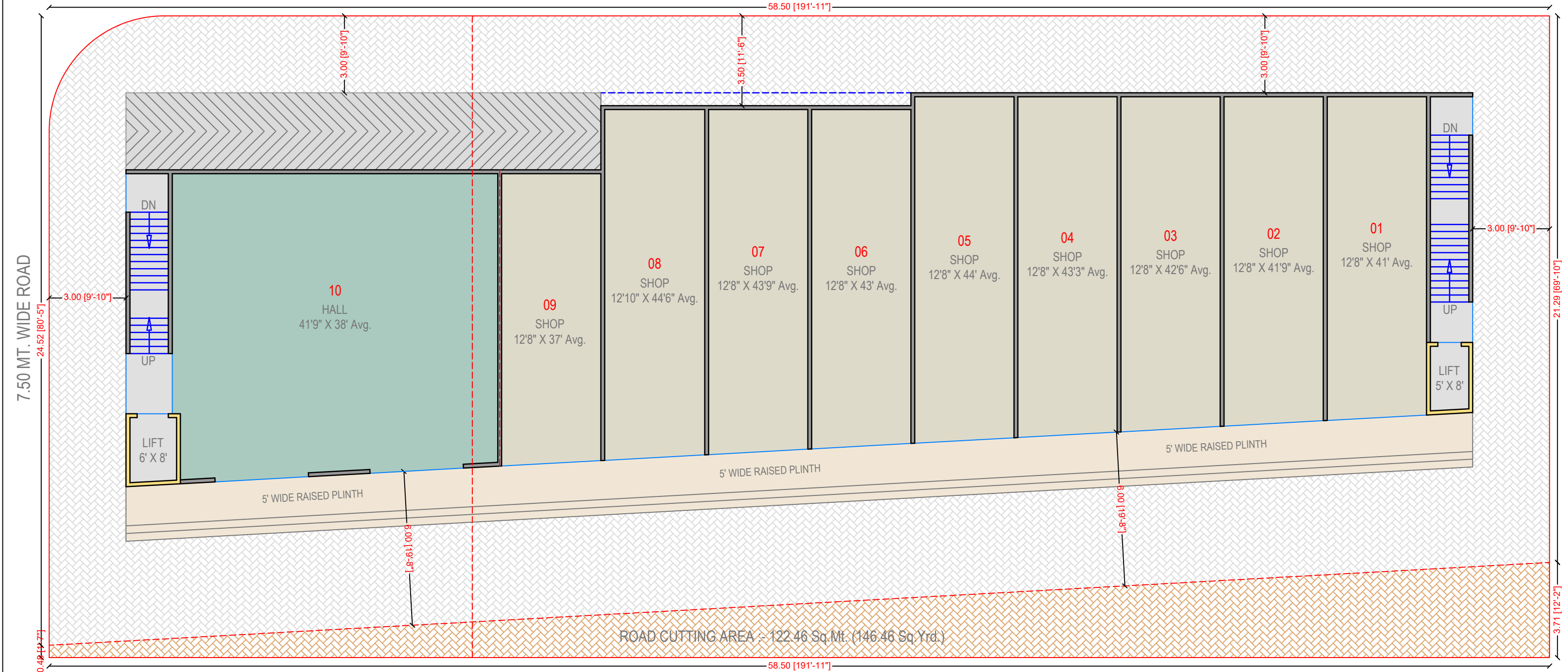

40.00 MT. WIDE D.P. ROAD

**GROUND FLOOR PLAN**

| GROUND FLOOR PLAN |             |               |                  |
|-------------------|-------------|---------------|------------------|
| Sr.No.            | Particular  | BUILT UP AREA | SUPER BUILT AREA |
| 1                 | SHOP NO. 1  | 558           | 781              |
| 2                 | SHOP NO. 2  | 557           | 780              |
| 3                 | SHOP NO. 3  | 567           | 794              |
| 4                 | SHOP NO. 4  | 576           | 807              |
| 5                 | SHOP NO. 5  | 586           | 821              |
| 6                 | SHOP NO. 6  | 574           | 804              |
| 7                 | SHOP NO. 7  | 584           | 817              |
| 8                 | SHOP NO. 8  | 600           | 839              |
| 9                 | SHOP NO. 9  | 495           | 692              |
| 10                | HALL NO. 10 | 1872          | 2621             |
| TOTAL             |             | 6969          | 9756             |

6.00 MT. WIDE ROAD

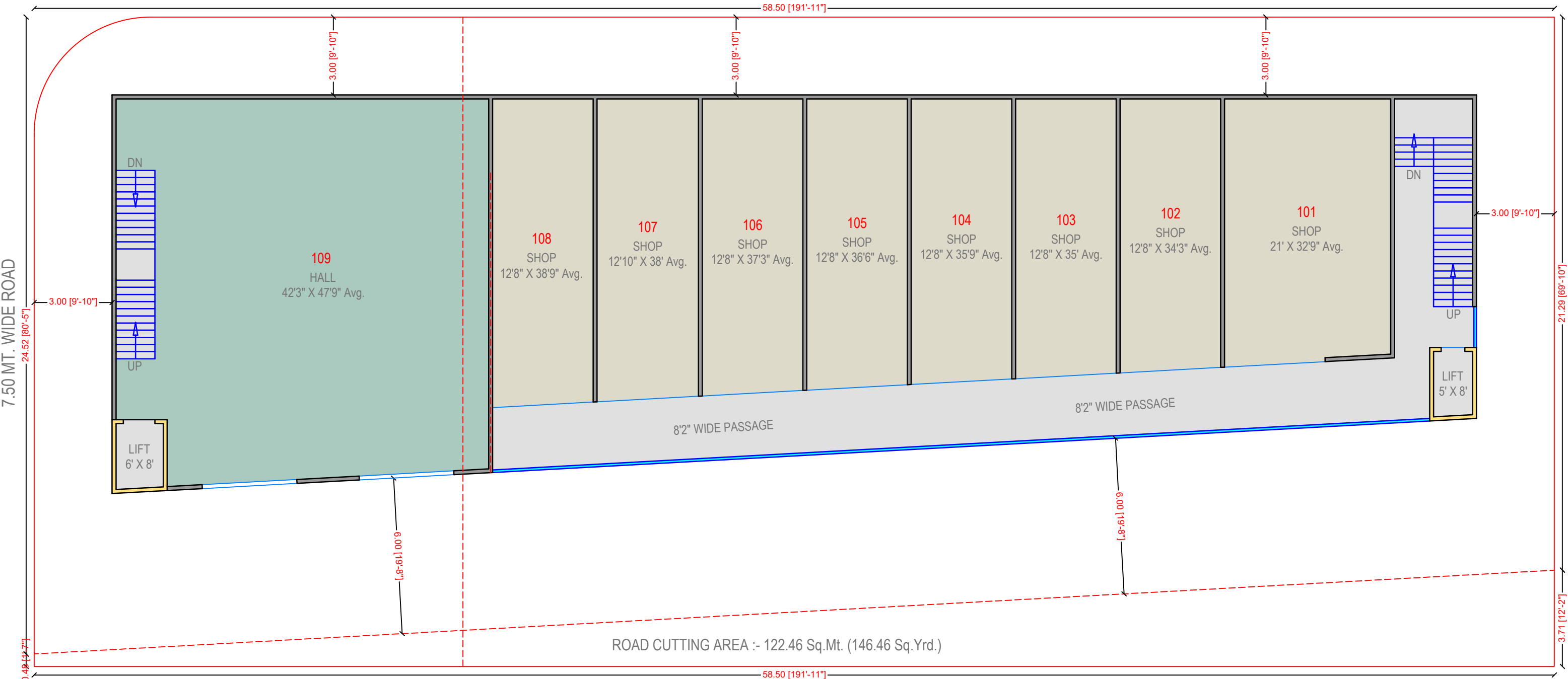

ROAD CUTTING AREA :- 122.46 Sq.Mt. (146.46 Sq.Yrd.)

40.00 MT. WIDE D.P. ROAD

**TYPICAL FLOOR PLAN**

| TYPICAL FLOOR PLAN (FIRST & SECOND) |              |               |                  |
|-------------------------------------|--------------|---------------|------------------|
| Sr.No.                              | Particular   | BUILT UP AREA | SUPER BUILT AREA |
| 1                                   | SHOP NO. 101 | 734           | 1027             |
| 2                                   | SHOP NO. 102 | 458           | 642              |
| 3                                   | SHOP NO. 103 | 468           | 655              |
| 4                                   | SHOP NO. 104 | 478           | 669              |
| 5                                   | SHOP NO. 105 | 487           | 682              |
| 6                                   | SHOP NO. 106 | 497           | 696              |
| 7                                   | SHOP NO. 107 | 510           | 714              |
| 8                                   | SHOP NO. 108 | 516           | 723              |
| 9                                   | HALL NO. 109 | 2343          | 3280             |
| TOTAL                               |              | 6491          | 9087             |